



Model:  
WS for Lutron Designer Style 2G BK-INST

Model No.: 10-01-564

Family: WALL-SMART

DWG NO. 10-04-564-SPC

PRODUCT SPEC.

REVISION A  
DATE 22/Feb./2016



**Make Your Wall Smart**

**Wall-Smart for Lutron Designer Style 1Gang - Product description:**

The "Wall-Smart for Lutron Designer Style 2G BK-INST" is an adapter for 2 gang in-wall flush installation of Lutron Designer style faceplate and high voltage decora® style accessories in solid surfaces.

The "Wall-Smart for Lutron Designer Style 2G BK-INST" securely mounts the designer style products while allowing easy access, insertion and removal.

**Key features and benefits:**

- Flush with the wall.
- Includes depth calibration mechanism and spacers allowing installation in wide range of board thicknesses:
  - For installation in boards 11mm ~ 19 mm (7/16" ~ 3/4") thick, use spacer frame A (thick spacer frame) and (x4) 40mm (1.6") screws.
  - For installation in boards 17mm ~ 29mm (0.67" ~ 1.14") thick, use spacer frame B (thin spacer frame) and (x4) 30mm (1.18") screws.
  - For installation in boards 22mm ~ 35mm (0.87" ~ 1.38") thick, do not install a spacer frame and use (x4) 30mm (1.18") screws.
- Allows easy maintenance access.
- Designed for the use with Lutron Designer Style products. (Lutron Designer style faceplate, high voltage decora® style and back box are not included)
- Use spacer frame B (thin spacer frame) as a routing template.

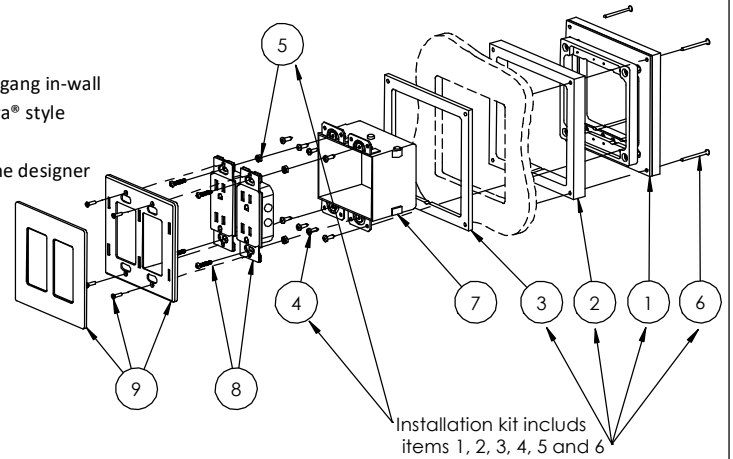

Installation kit includes items 1, 2, 3, 4, 5 and 6

**Kit includes:**

- (x1) Wall adaptor (item #1)
- (x1) Spacer frame A (thick spacer frame) (item #2)
- (x1) Spacer frame B (thin spacer frame) (item #3)
- (x8) ST3 screws (item #4)
- (x4) Installation spacer (item #5)
- (x4) Adapter mounting screws ST3 X40mm (item #6)

**Kit does not include:**

- Metal back box, Hubbel-Raco 420 (or equivalent) (item #7)
- Lutron product to be installed in Designer Style wallplate (item #8)
- Lutron Designer Style wallplate (item #9)

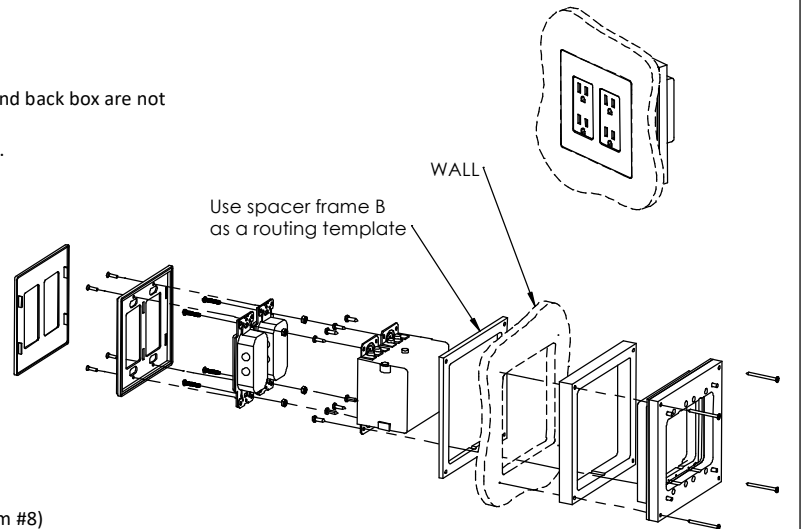

**Key properties:**

- Dimensions (W/H/D): 146.7mm (5.78")/ 145.1mm (5.71")/ 40mm (1.57")
- Power Supply: None (manual adapter).
- Weight: 0.44Kg, 0.968lb.
- To be installed in 7/16" ~ 1.38" solid boards.

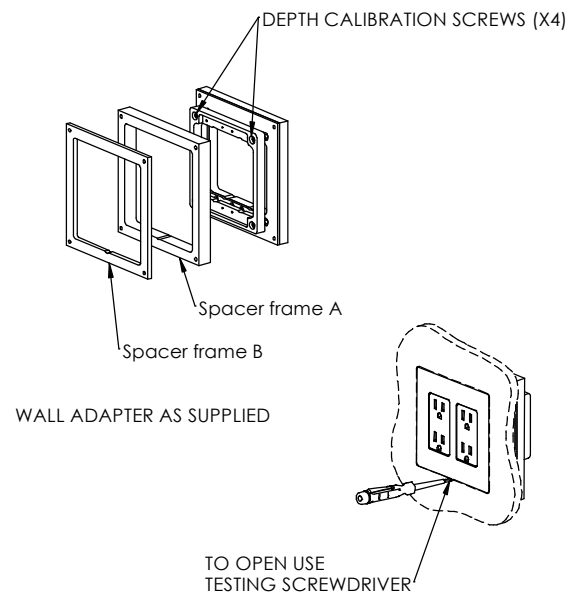
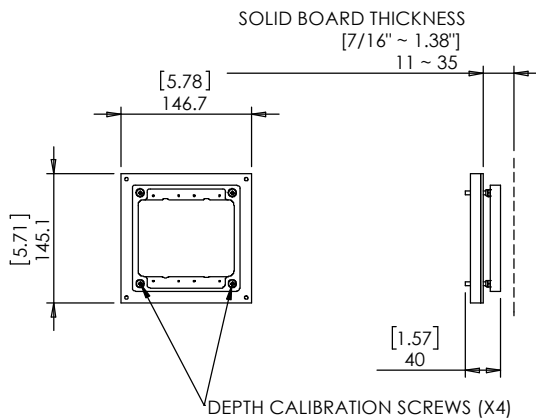



Model:  
WS for Lutron Designer Style 2G BK-INST

Model No.: 10-01-564

Family: WALL-SMART

DWG NO. 10-04-564-SPC

PRODUCT SPEC.

REVISION A

DATE 22/Feb./2016

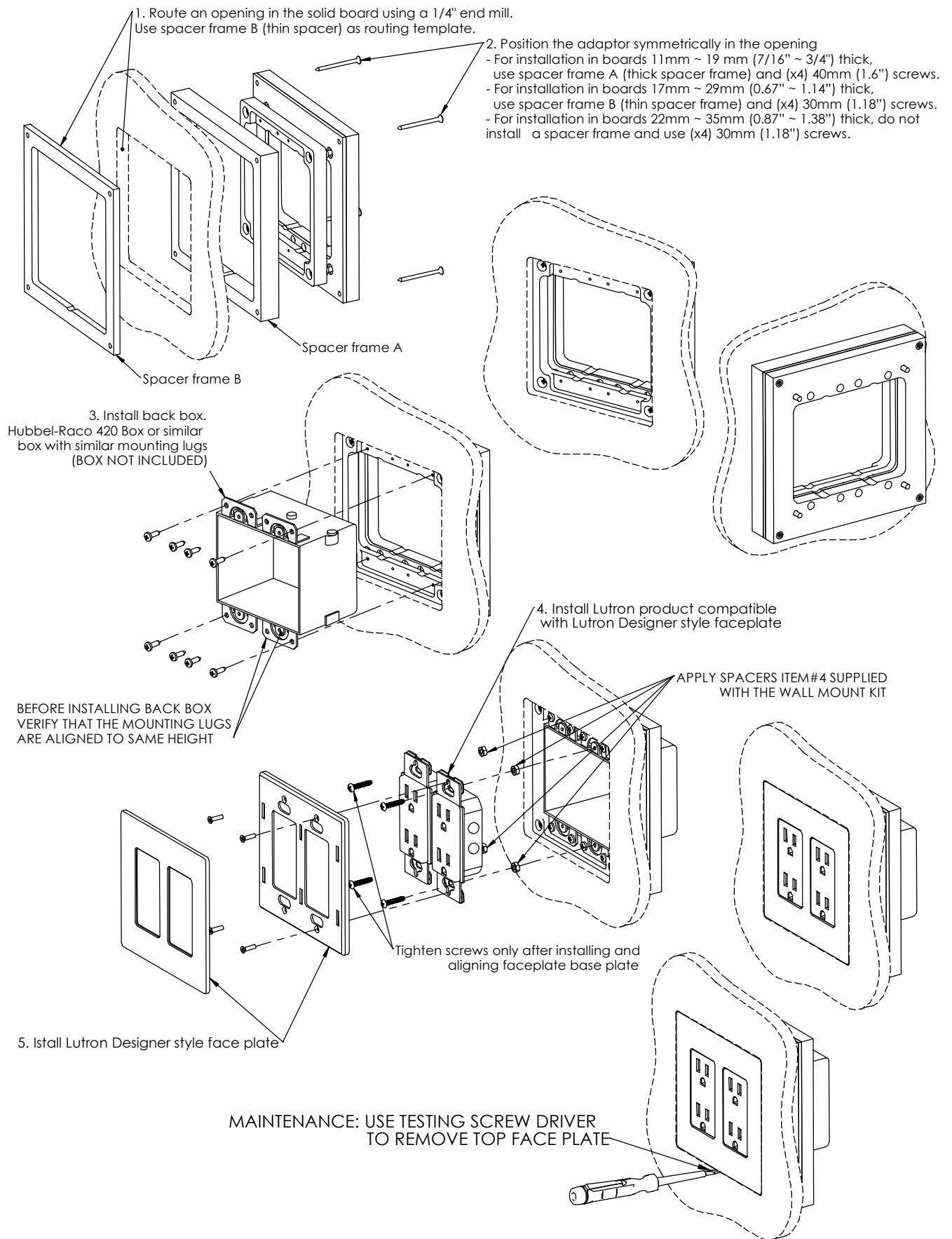



Model:  
WS for Lutron Designer Style 2G BK-INST

Family: WALL-SMART  
DWG NO. 10-04-564-SPC



Model No.: 10-01-564

PRODUCT SPEC.

REVISION A  
DATE 22/Feb./2016

# ROUTING TEMPLATE 1:1

