



Model:
WS SB for International seeTouch® keypad OFF

Family: WALL-SMART
DWG NO. 10-04-187-SPC



Model No.: 10-01-187

PRODUCT SPEC.

REVISION A
DATE 10/NOV./2017

Make Your Wall Smart

“WS SB for International seeTouch® keypad OFF” - Product description:

The “WS SB for International seeTouch® keypad OFF” is an adapter for in-wall flush installation of a HWIS-XX-F-SC keypad in solid board walls.

The “WS SB for International seeTouch® keypad OFF” firmly mounts the keypad while allowing easy access, insertion and removal.

Key features and benefits:

- Flush with the wall.
- Allows easy insertion and removal of the keypad by manual push and magnet detachment.
- Designed to be installed in 1.52 ~ 30.52mm (0.06” ~ 1.2”) thick solid boards.
- Installation adapter contains depth adjustment mechanism.
- Installation kit contain:
X1 routing template (item #1)
X1 installation adapter (item #2)
X4 ST3x40 screws (item #3)
- Designed for HWIS-XX-F-SC keypad (by Lutron) (keypad is not included).

Key properties:

- Dimensions (W/H/D): 119.6mm (4.7")/ 119.6mm (4.7")/ 41mm (1.61")
- Power Supply: None (manual adapter).
- Weight: 0.42Kg, 0.924lbs.
- Material: Moisture resistant MDF

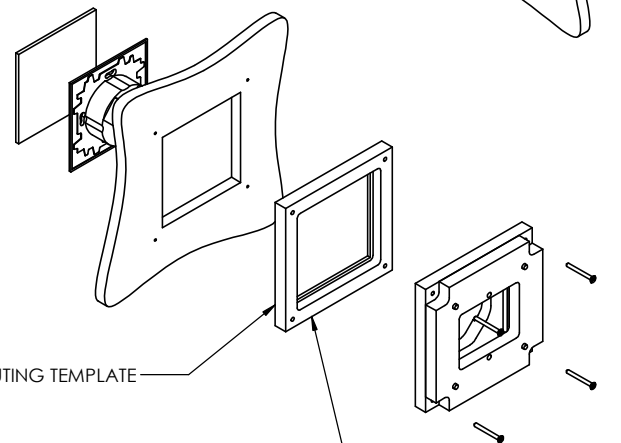
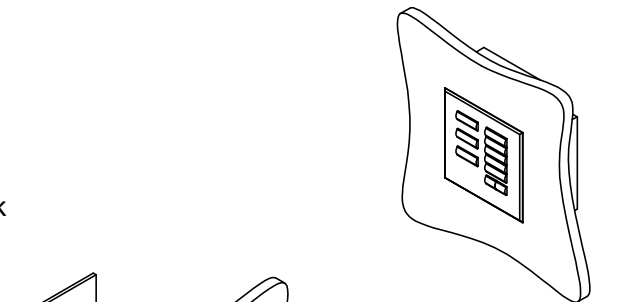
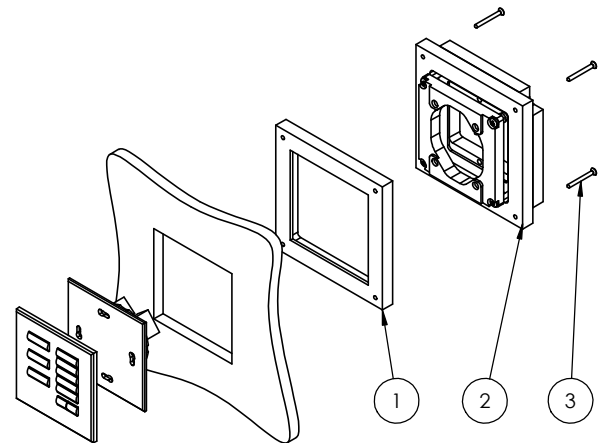

ROUTING TEMPLATE

FOR INSTALLATION IN BOARDS 1.52mm TO 18.92mm THICK
USE ROUTING TEMPLATE AS INSTALLATION SPACER

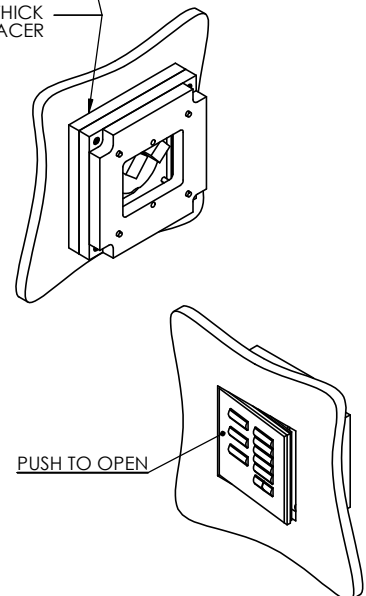

PUSH TO OPEN

FRONT SURFACE OF SOLID BOARD

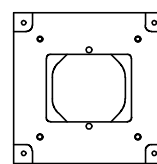
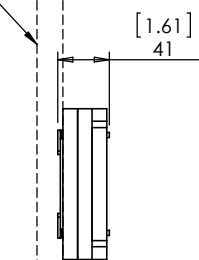
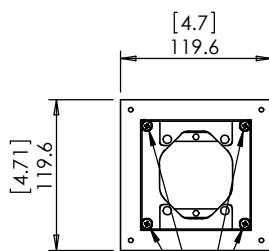

DEPTH ADJUSTMENT SCREWS

SOLID BOARD THICKNESS RANGE:
1.52 ~ 18.92 [0.06"~0.74"] WITH SPACER
13.12 ~ 30.52 [0.52"~1.2"] WITHOUT SPACER



Model:
WS SB for International seeTouch® keypad OFF

Family: WALL-SMART
DWG NO. 10-04-187-SPC



Model No.: 10-01-187

PRODUCT SPEC.

REVISION A
DATE 10/NOV./2017

1:1 TEMPLATE FOR (10-01-187) WS SB for International seeTouch® keypad OFF

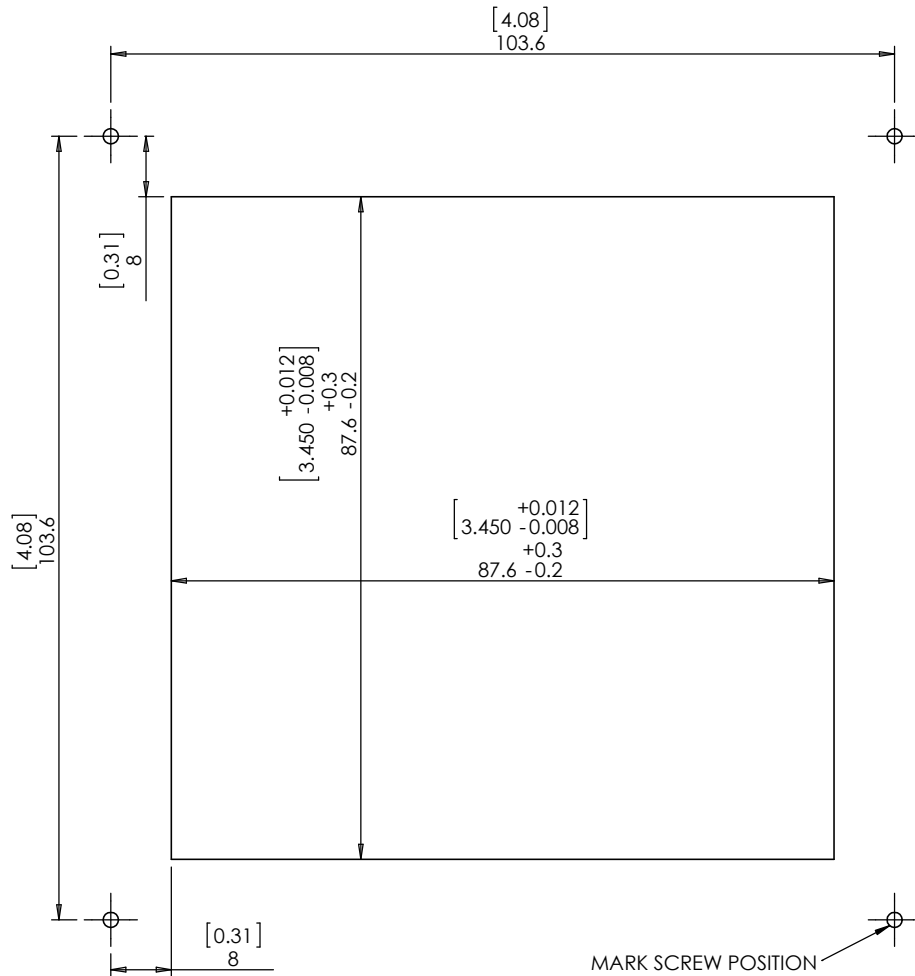

Download template DXF file:

<http://www.wall-smart.com/uploads/2/4/1/6/24165207/10-04-187-template.dxf>