



Model:
WS for Lutron Designer Style 1G BK-INST

Family: WALL-SMART
DWG NO. 10-04-174-SPC



Model No.: 10-01-174

PRODUCT SPEC.

REVISION D
DATE 22/July/2016

Make Your Wall Smart

Wall-Smart for Lutron Designer Style 1G BK-INST - Product description:

The "Wall-Smart for Lutron Designer Style 1G BK-INST" is an adapter for 1 gang in-wall flush installation of a Lutron Designer style faceplate and high voltage decora® style accessories in solid surfaces.

The "Wall-Smart for Lutron Designer Style 1G BK-INST" securely mounts the designer stile faceplate & accessory while allowing easy access, insertion and removal.

Key features and benefits:

- Flush with the wall.
- Includes depth calibration mechanism and a spacer allowing installation in wide range of board thicknesses:
 - For installation in boards 3mm ~ 19 mm (0.12" ~ 0.75") thick, install spacer.
 - For installation in boards 14mm ~ 30.6mm (0.55" ~ 1.2") thick, do not install spacer.
- Allows easy maintenance access.
- Designed for the use with Lutron Designer Style faceplate. (Lutron Designer style faceplate, high voltage decora® style accessories and back box are not included)
- Use the spacer frame as a routing template. In case a routing CAD file required contact support@wall-smart.com

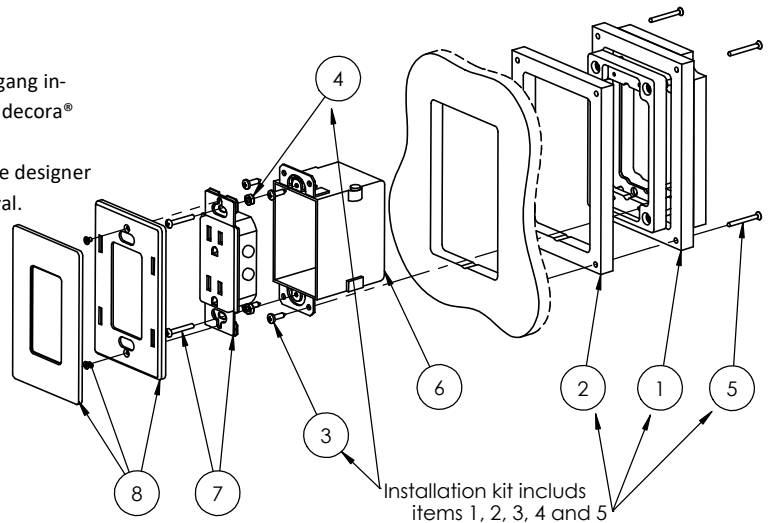

Kit includes:

- (x1) Wall adaptor (item #1)
- (x1) Spacer frame / routing template (item #2)
- (x4) ST3 screws (item #3)
- (x2) Installation spacer (item #4)
- (x4) Adapter mounting screws ST3 X40mm (item #5)

Kit does not include:

- Metal back box, Hubbel-Raco 420 (or equivalent) (item #6)
- high voltage decora® style accessory to be installed in Designer Style faceplate (item #7)
- Lutron Designer Style faceplate (item #8)

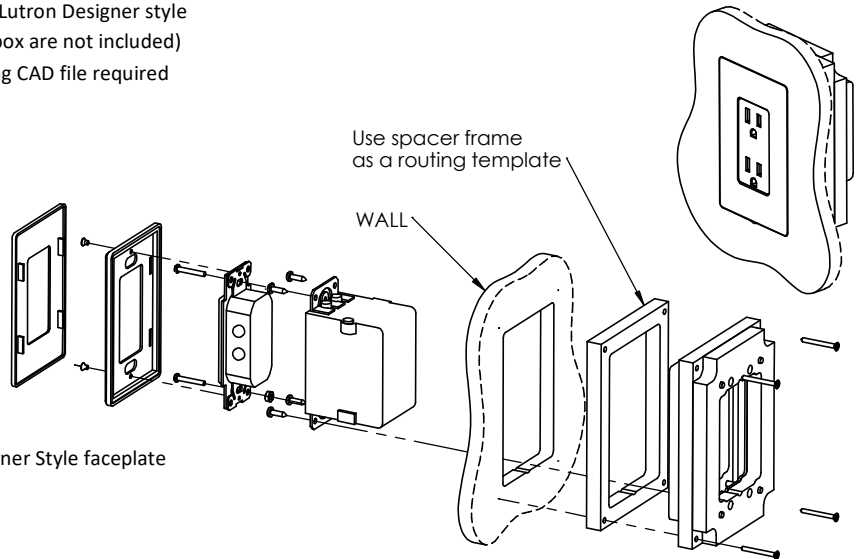

Key properties:

- Dimensions (W/H/D): 100.7mm (3.96")/ 145.1mm (5.71")/ 40.7mm (1.6")
- Power Supply: None (manual adapter).
- Weight: 0.22Kg, 0.48lb.
- To be installed in 0.12" ~ 1.2" solid boards.
- Material: Moisture resistant MDF

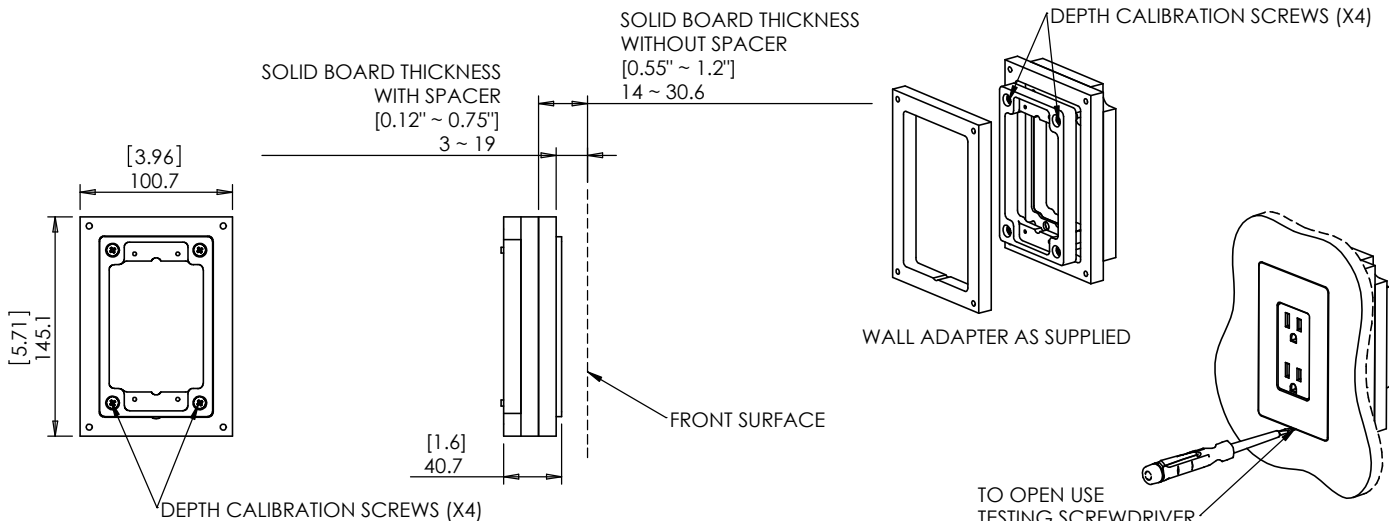



Model:
WS for Lutron Designer Style 1G BK-INST

Family: WALL-SMART
DWG NO. 10-04-174-SPC



Model No.: 10-01-174

PRODUCT SPEC.

REVISION D
DATE 22/July/2016

1. Route an opening in the solid board using a 1/4" end mill.
Use the spacer frame as routing template.

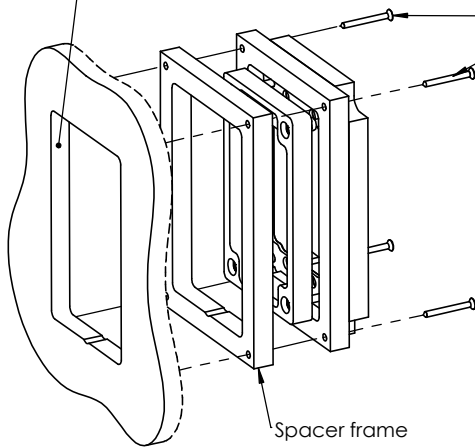

2. Position the adaptor symmetrically in the opening and retain the adaptor using 4 screws.
- For installation in boards 3mm ~ 19 mm (0.12" ~ 0.75") thick, install spacer.
- For installation in boards 14mm ~ 30.6mm (0.55" ~ 1.2") thick, do not install spacer.

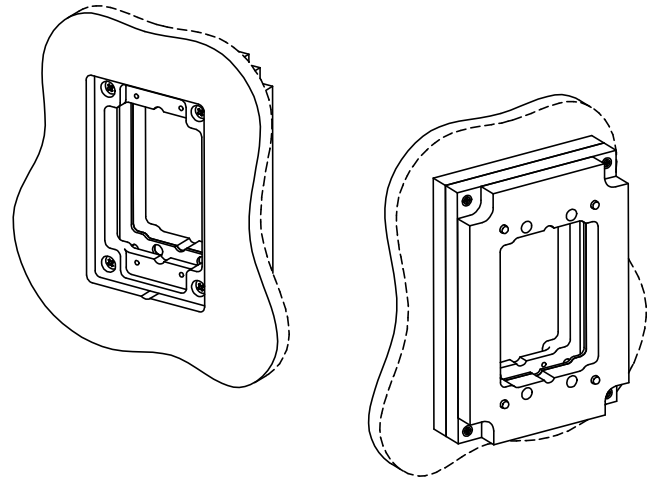

3. Install back box.
Hubbel-Raco 420 Box or similar box with similar mounting lugs
(BOX NOT INCLUDED)

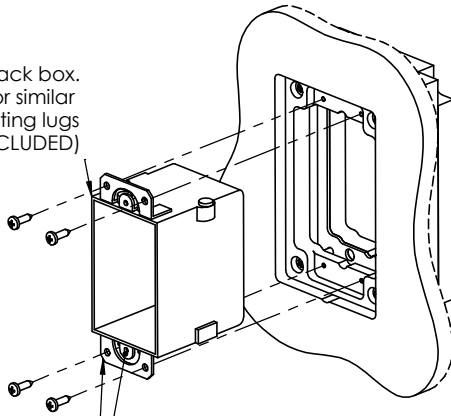

BEFORE INSTALLING BACK BOX
VERIFY THAT THE MOUNTING LUGS
ARE ALIGNED TO SAME HEIGHT

4. Install Lutron product compatible
with Lutron Designer style faceplate

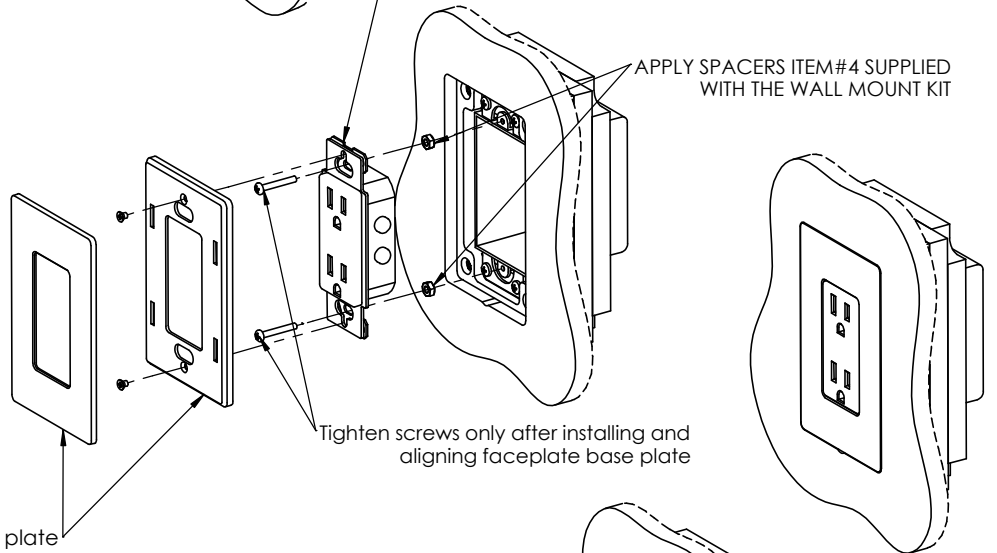

APPLY SPACERS ITEM#4 SUPPLIED
WITH THE WALL MOUNT KIT

Tighten screws only after installing and
aligning faceplate base plate

5. Install Lutron Designer style face plate

MAINTENANCE: USE TESTING SCREW DRIVER
TO REMOVE TOP FACE PLATE

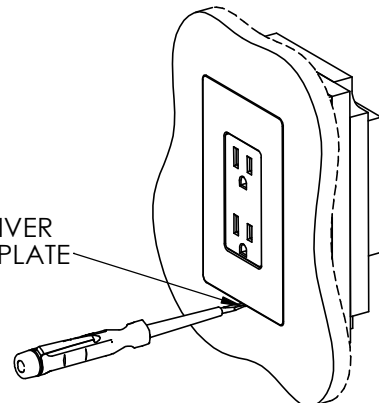



Model:
WS for Lutron Designer Style 1G BK-INST

Family: WALL-SMART
DWG NO. 10-04-174-SPC

Model No.: 10-01-174

PRODUCT SPEC.

REVISION C
DATE 22/Feb./2016



ROUTING TEMPLATE 1:1

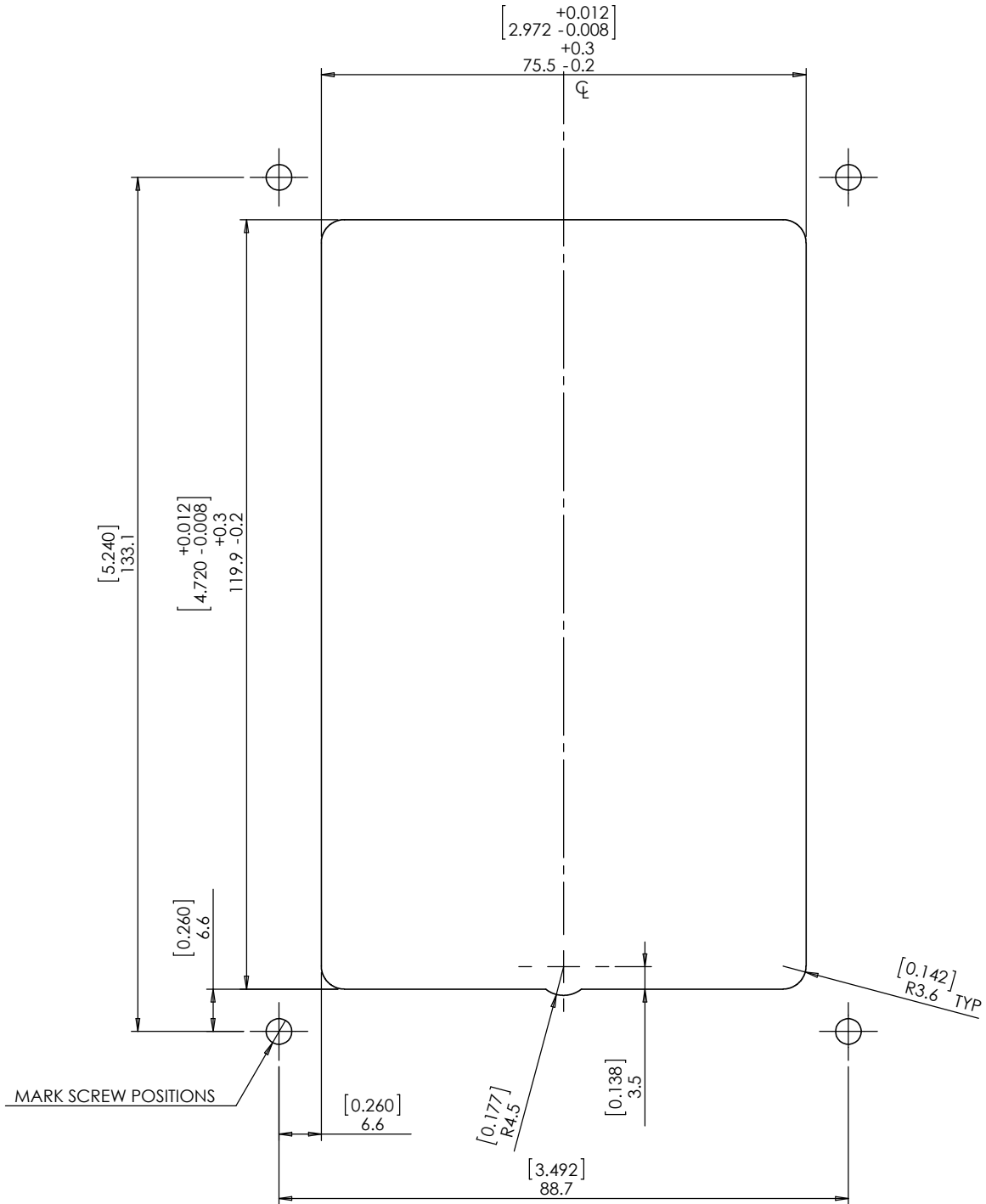

TEMPLATE DXF LINKS:
<http://www.wall-smart.com/uploads/2/4/1/6/24165207/10-04-174-template.dxf>