



Model: WS SB FOR BLACK NOVA
2 MODULE LINE V

Family: WALL-SMART

DWG NO. 084-4-930-SPC

Model No.: 084-1-930

PRODUCT SPEC.

REVISION A

DATE 30/DEC./2022



Make Your Wall Smart

“WS SB FOR BLACK NOVA 2MODULE LINE V” - Product description:

The “WS SB FOR BLACK NOVA 2MODULE LINE V” is an adapter for in-wall flush installation of a Black Nova line voltage 2module faceplate and devices in solid board walls.

The “WS SB FOR BLACK NOVA 2MODULE LINE V” firmly mounts the faceplate and devices while allowing easy access, insertion and operation.

Key features and benefits:

- Flush with the wall.
- Includes depth calibration mechanism and a spacer.
- Allowing installation in wide range of board thicknesses:
With spacer: 7.78mm ~ 22.46mm [0.31" ~ 0.88"] thick.
Without spacer 19.38mm ~ 34.1mm [0.76" ~ 1.34"] thick.
- Designed for the use with Black Nova 2 Module faceplates and line voltage devices and low voltage devices (faceplate and Black Nova devices not included).
- Adapter kit contains:
 1. Wall adapter (x1)
 2. Installation spacer (x1)
 3. KA3.5X8 Screws (x8)
 4. ST3x40 screws (x4)

Key properties:

- Dimensions (W/H/D): 228.2mm (8.98")/ 128.2mm (5.05")/ 56mm (2.2")
- Power Supply: None (manual adapter).
- Weight: 0.4Kg, 0.88lbs.
- Material: Moisture resistant MDF.

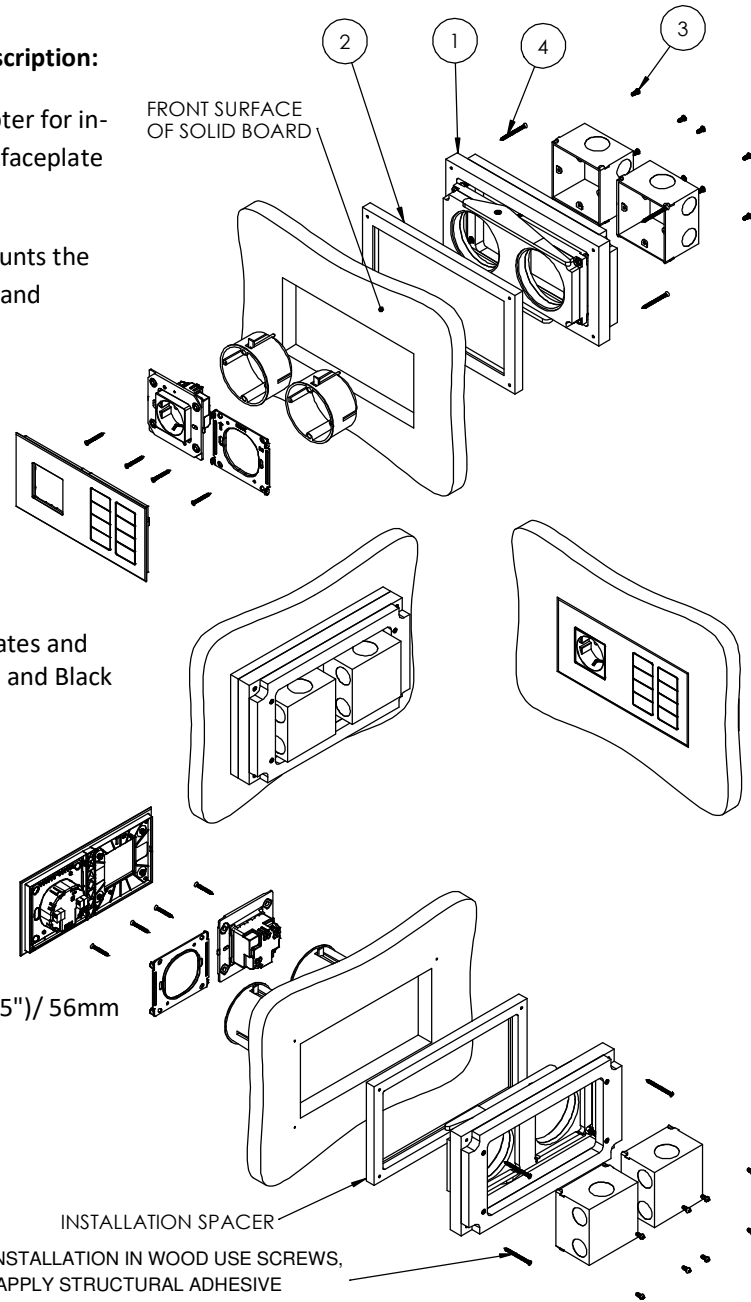

SOLID BOARD THICKNESS RANGE:
7.78 ~ 22.46 [0.3~0.88] WITH SPACER
19.38 ~ 34.06 [0.79~1.34] WITHOUT SPACER

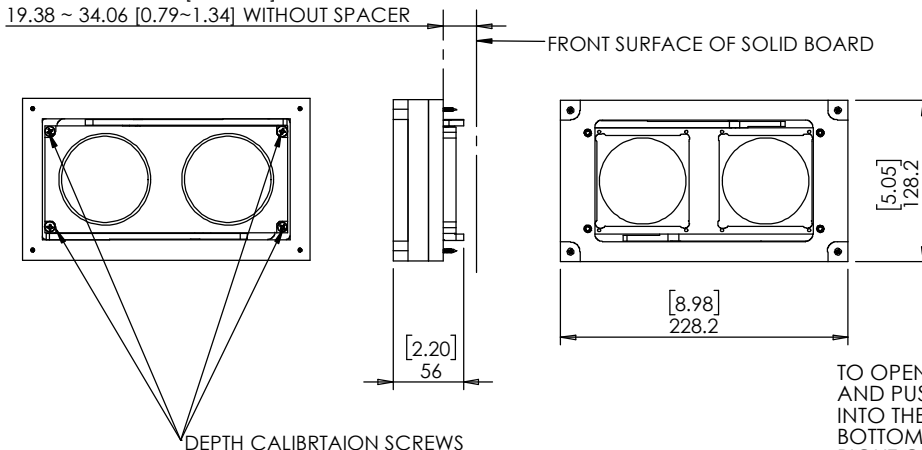

TO OPEN THE FACEPLATE, INSERT AND PUSH A THIN PLASTIC CARD INTO THE HORIZONTAL GAP ON THE BOTTOM LEFT OR ON THE TOP RIGHT CORNERS



Model: WS SB FOR BLACK NOVA
2 MODULE LINE V

Family: WALL-SMART

DWG NO. 084-4-930-SPC

Model No.: 084-1-930

PRODUCT SPEC.

REVISION A
DATE 30/DEC./2022



BACK BOX INSTALLTION INSTRUCTIONS:

INSTALLTION WITH 2X 1GANG JUNCTION BOX FOR HOLE Ø68mm (DIN 49073-1)

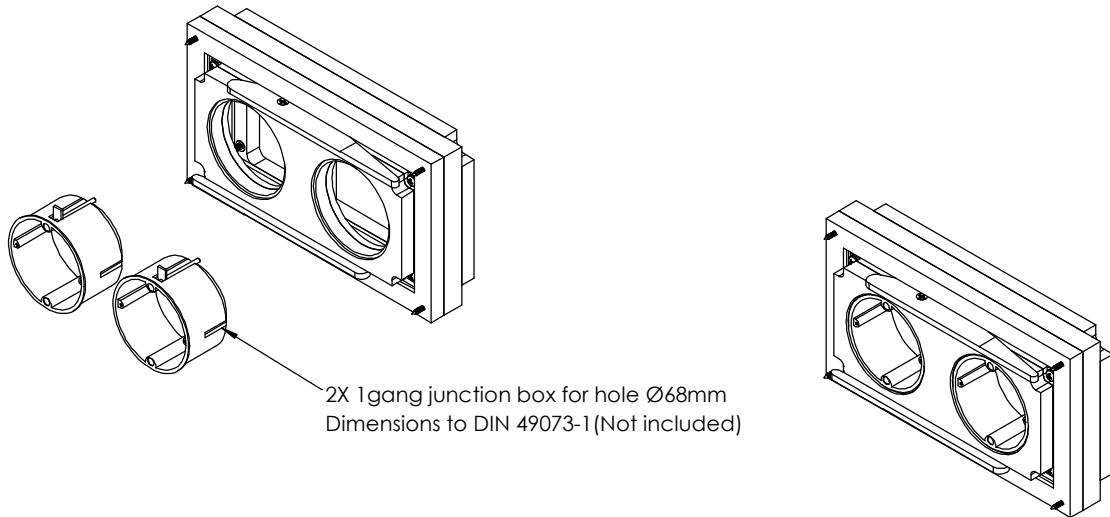

INSTALLTION WITH BS4662 2X 1GANG BACK BOX

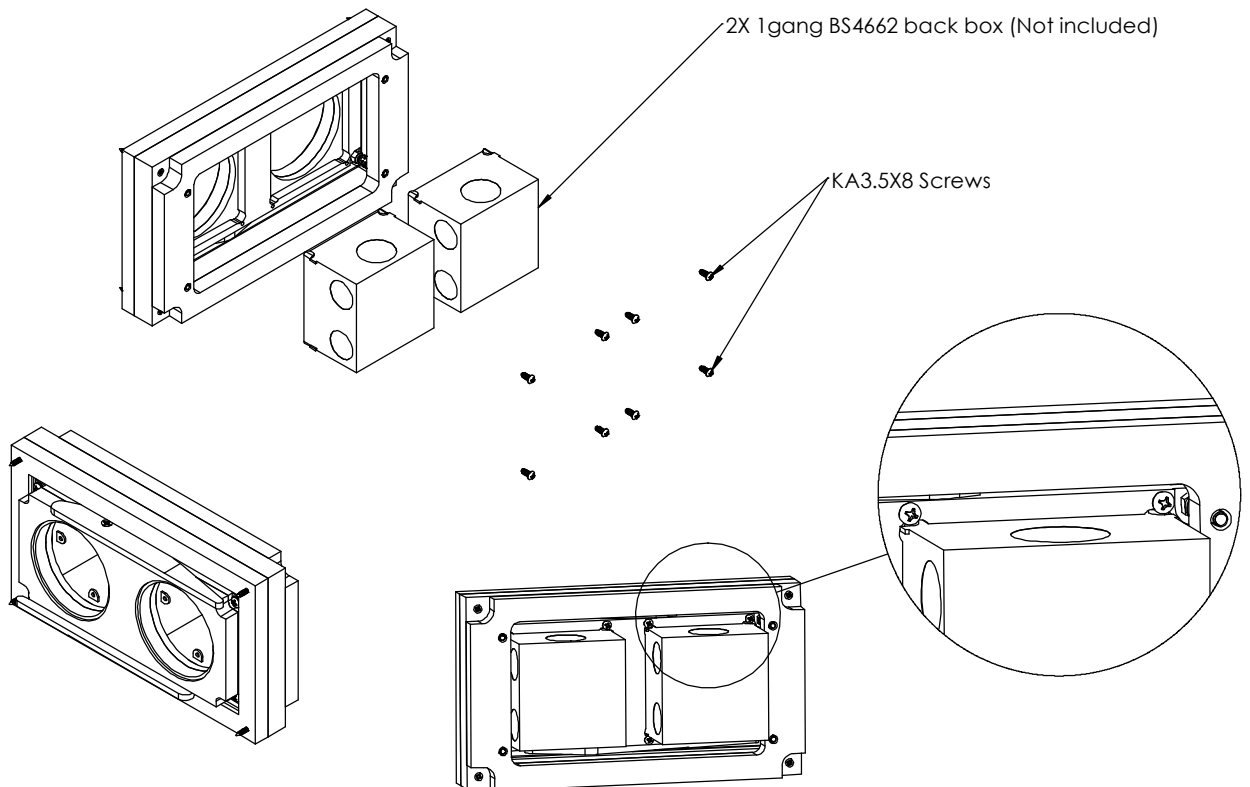



Model: WS SB FOR BLACK NOVA
2 MODULE LINE V

Family: WALL-SMART

DWG NO. 084-4-930-SPC

Model No.: 084-1-930

PRODUCT SPEC.

REVISION A

DATE 30/DEC./2022



CUTOUT ROUTING TEMPLATE SCALE 1:1

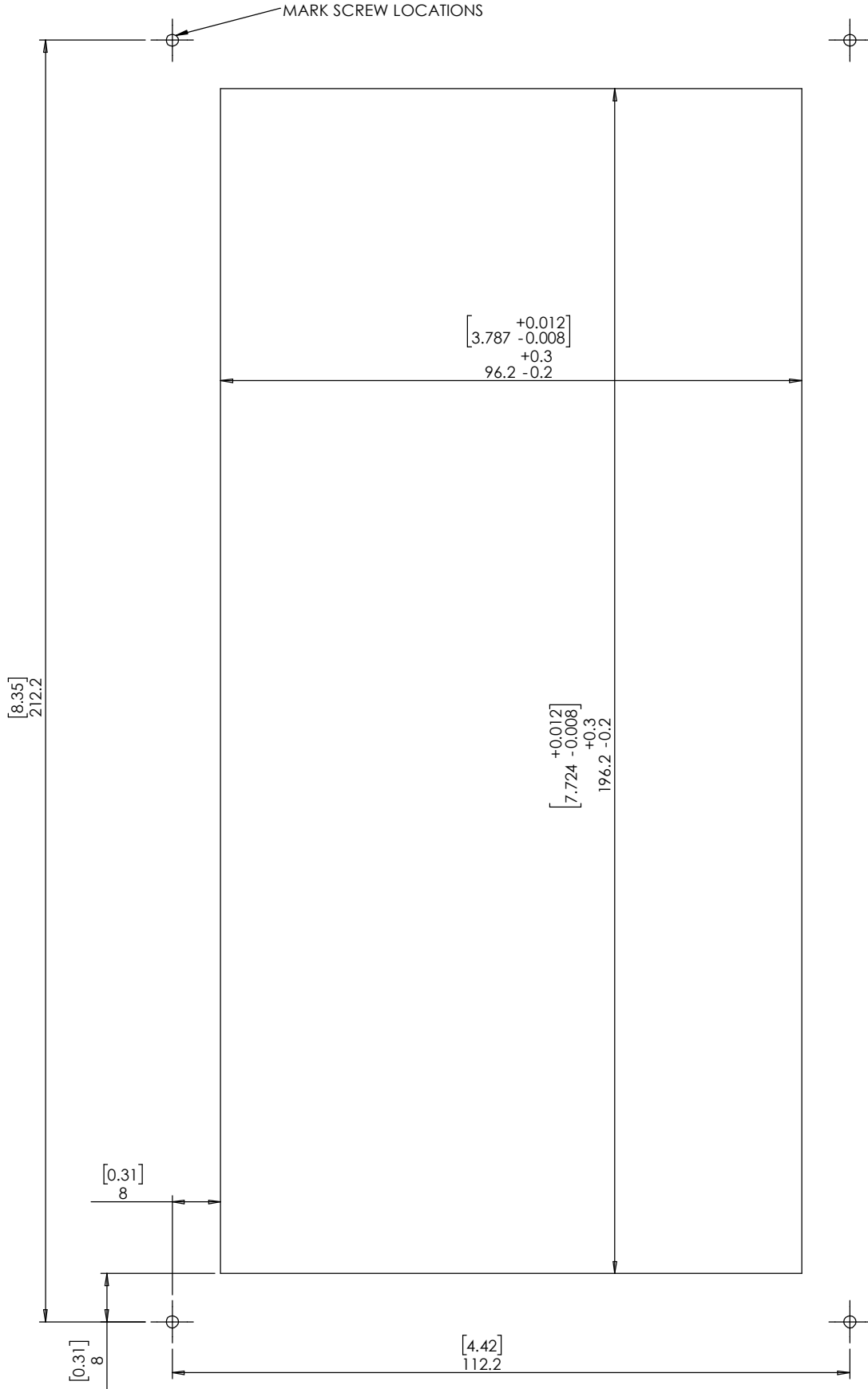

PRINT THIS PAGE 1:1 SCALE