



Model: WS RETROFIT FOR CRESTRON TST-902-DSW

Model No.: 012-1-398

Family: RETROFIT

DWG NO. 012-4-398-SPC

PRODUCT SPEC.

REVISION A

DATE 3/15/2019



**Make Your Wall Smart**

**“WS RETROFIT FOR CRESTRON TST-902-DSW” - Product description:**

The “WS RETROFIT FOR CRESTRON TST-902-DSW” is an adapter for in-wall nearly flush retrofit installation of a TST-902 touch screen and a TST-902-DSW wall dock.

The “WS RETROFIT FOR CRESTRON TST-902-DSW” firmly mounts the touch screen while allowing easy access, insertion and operation.

**Key features and benefits:**

- Nearly flush with the wall (4mm [0.16"] thick on-wall bezel).
- Allows easy insertion and removal of the touch screen.
- The adapter is supplied unpainted (To be painted after installation as part of the wall).
- Bezel attaches magnetically to the retrofit wall mount base.
- The bezel is supplied painted black.
- Wall board thickness 10mm[0.39"] up to 21mm[0.83"]. For boards up to 32mm[1.25"] thick, reinstall cam latches upside down.
- Designed for the use with TST-902 touch screen and TST-902-DSW wall dock (by Crestron Electronics, Inc. ©) (touch screen and wall dock are not included).
- Adapter kit contains:
  - (X1) Wall adapter (item 1)
  - (X4) ST3x17 Screws (item 2)
  - (X2) THREAD-FORMING SCREW #6X<sup>5</sup>/<sub>16</sub>" (item 3)
  - (X1) Button (item 4)
  - (X1) Right panel (item 5)
  - (X1) Left panel (item 6)
  - (X1) Bezel (item 7)

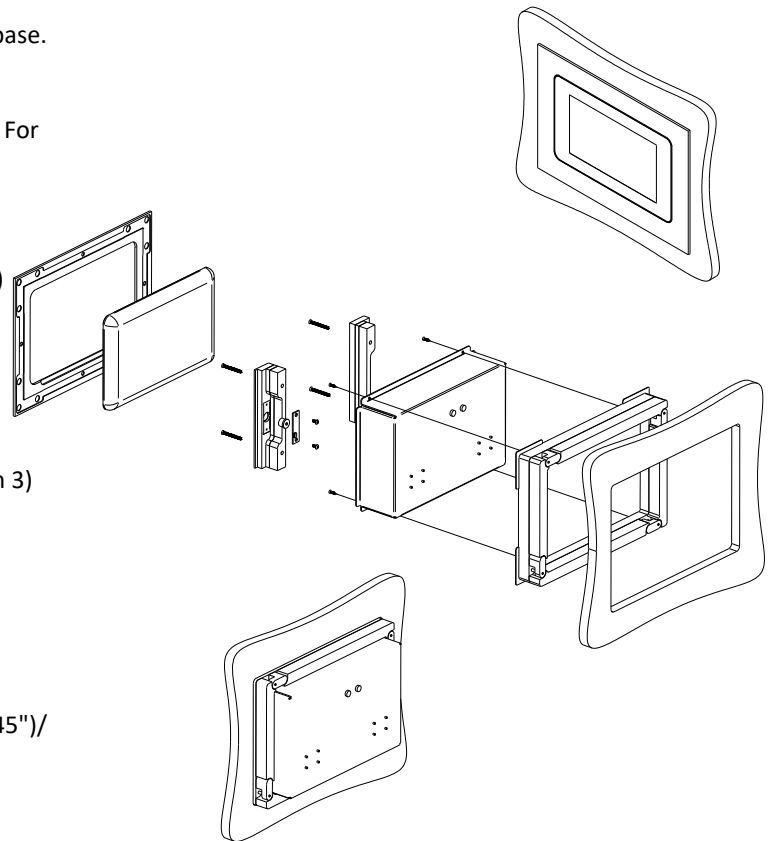
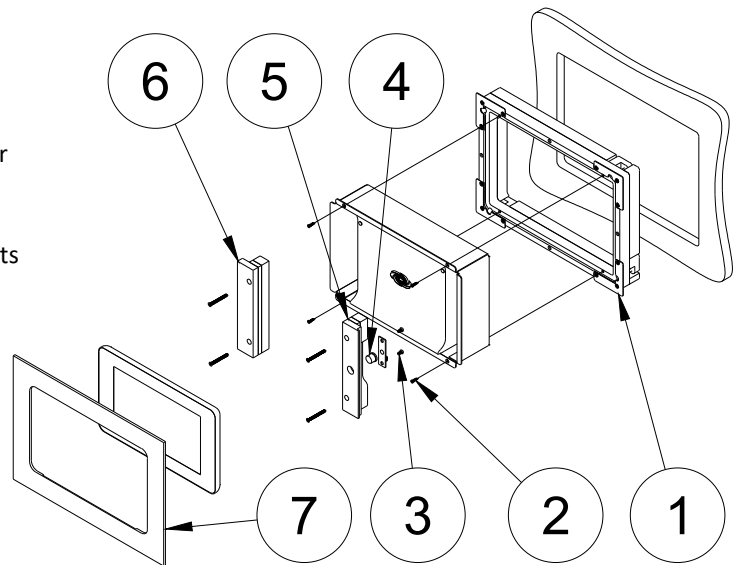

**Key properties:**

- Dimensions (W/H/D): 337.6mm (13.29")/ 239.9mm (9.45")/ 47mm (1.85")
- Weight: 0.8Kg, 1.8lbs.
- Material: Moisture resistant MDF

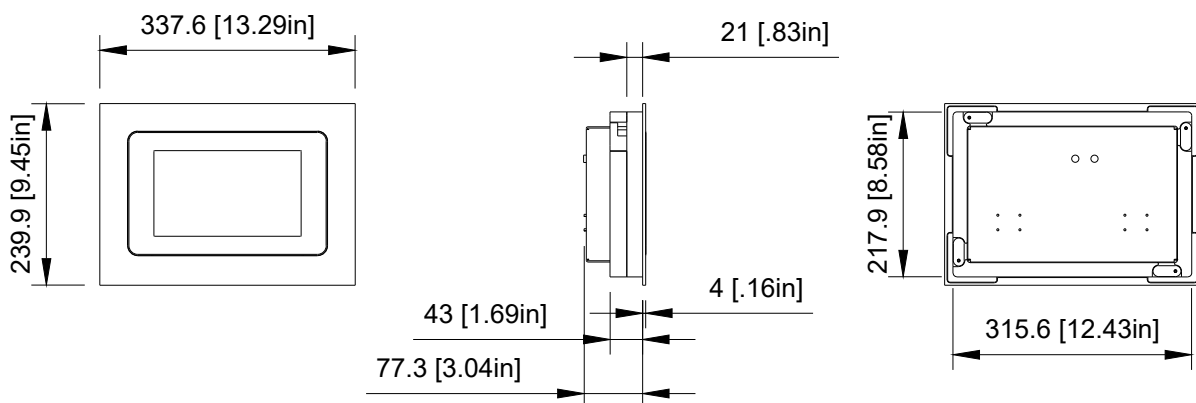



Model: WS RETROFIT FOR  
CRESTRON TST-902-DSW

Model No.: 012-1-398

Family: RETROFIT

DWG NO. 012-4-398-SPC

PRODUCT SPEC.

REVISION A

DATE 3/15/2019

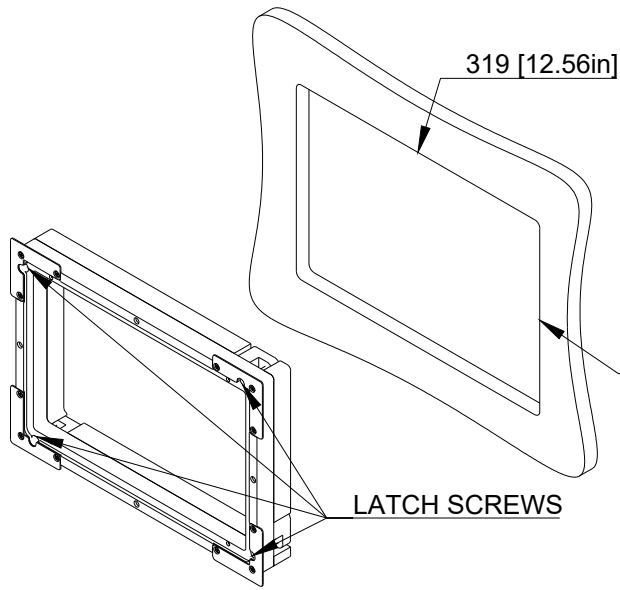

1. CUT OPENING - BOARD THICKNESS 10mm [0.39"] UP TO 21mm [0.83"] (FOR BOARDS UP TO 32mm [1.25"] THICK, REINSTALL CAM LATCHES UPSIDE DOWN.
2. ROUTE NECESSARY CABLES.
3. INSERT WALL MOUNT BASE AND LOCK IN PLACE BY ROTTATING THE LACH SCREWS.

4. CONNECT CABLE AND INSERT TST-902-DSW. RETAIN THE UNIT USING 4 ST3X17 SCREWS.
5. UNSCREW THE BUTTON PCB OF THE TST-902-DSW COVER.
6. INSERT THE BUTTON IN TO THE RIGHT PANET AND ATTACHED THE BUTTON PCB USING 2 #6 SCREWS.
7. ATTACHED THE BUTTON CABLE TO THE PCB.
8. INSTALL THE LEFT AND THE RIGHT PANELS USING 4 SCREWS SUPPLIED WITH THE TST-902-DSW.

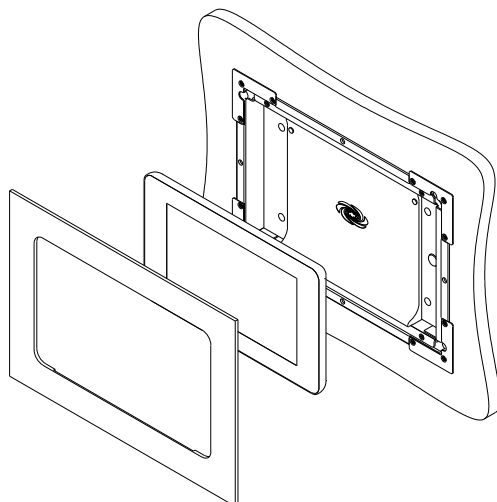
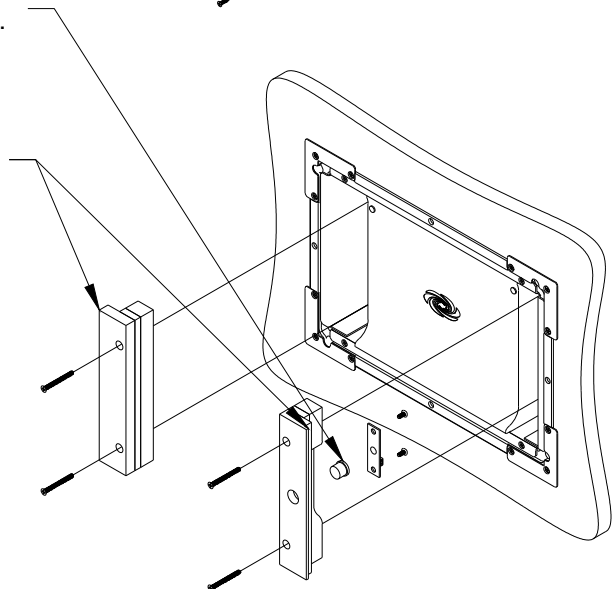
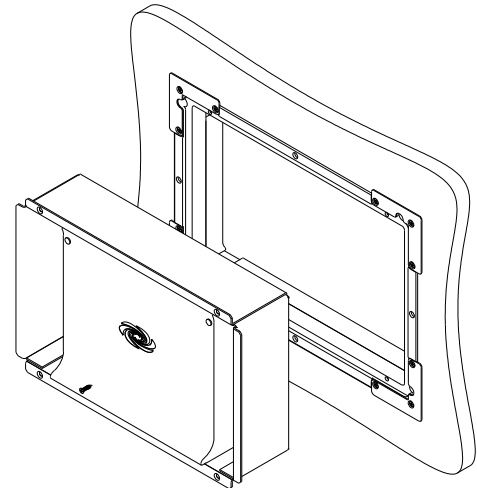

9. INSERT THE TST-902 TOUCH SCREEN.
10. ATTACHED THE BEZEL.