



Model: WS RETROFIT FOR TSW-1060 BLACK/WHITE

Family: WALL-SMART

DWG NO. 10-04-756-SPC

Model No.: 10-01-756-BL/-WH

PRODUCT SPEC.

REVISION B

DATE 8/DEC./2017



Make Your Wall Smart

“WS RETROFIT FOR TSW-1060 BLACK\WHITE” - Product description:

The “WS RETROFIT FOR TSW-1060 BLACK\WHITE” is an adapter for in-wall nearly flush retrofit installation of a TSW-1060 touch screen. The “WS RETROFIT FOR TSW-1060 BLACK\WHITE” firmly mounts the TSW-1060 touch screen while allowing easy insertion, removal and operation.

Key features and benefits:

- Nearly flush with the wall (4mm [0.16"] thick on-wall bezel).
- Wall mount may be mounted in any orientation.
- Allows easy insertion and removal of the touch screen.
- Bezel attaches magnetically to the retrofit wall mount base.
- The bezel is supplied painted black (-BL), white (-WH) or unpainted (-WO)
- The bezel is supplied, by default, with speaker and mic grills.
- Designed for the use with TSW-1060 touch screen (by Crestron Electronics, Inc. ©) (touch panel is not included).
- Adapter kit contains:
 1. (X1) Wall mount base;
 2. (X1) Bezel;

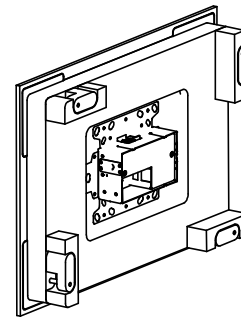
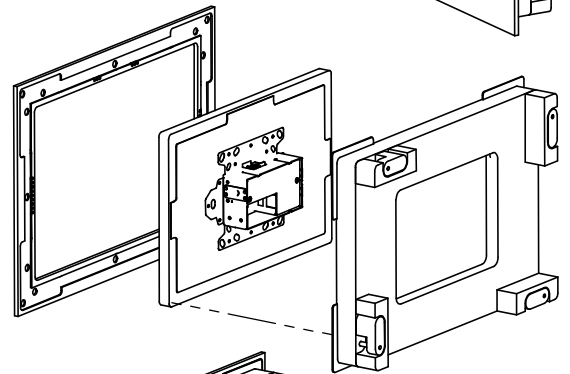
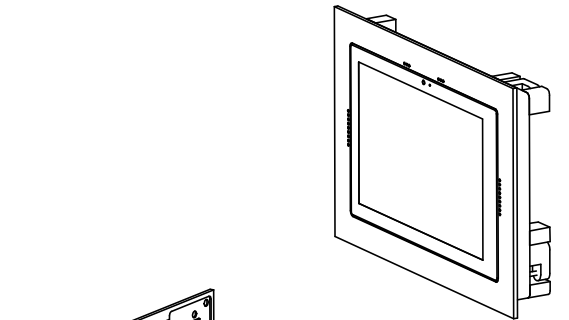
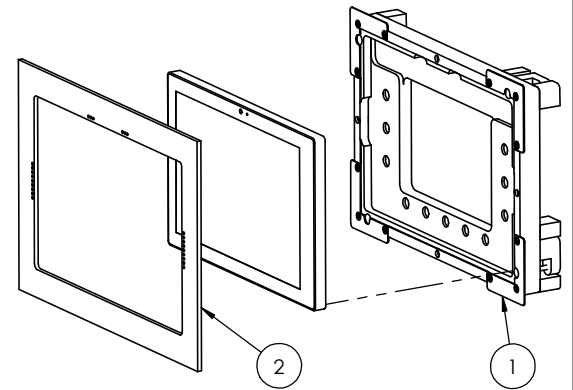

Key properties:

- Dimensions: (W/H/D): 314.6mm (12.39")/ 222.3mm (8.75")/ 47mm (1.85")
- Weight: 2.8Kg, 6.16lbs.
- Material: Moisture resistant MDF

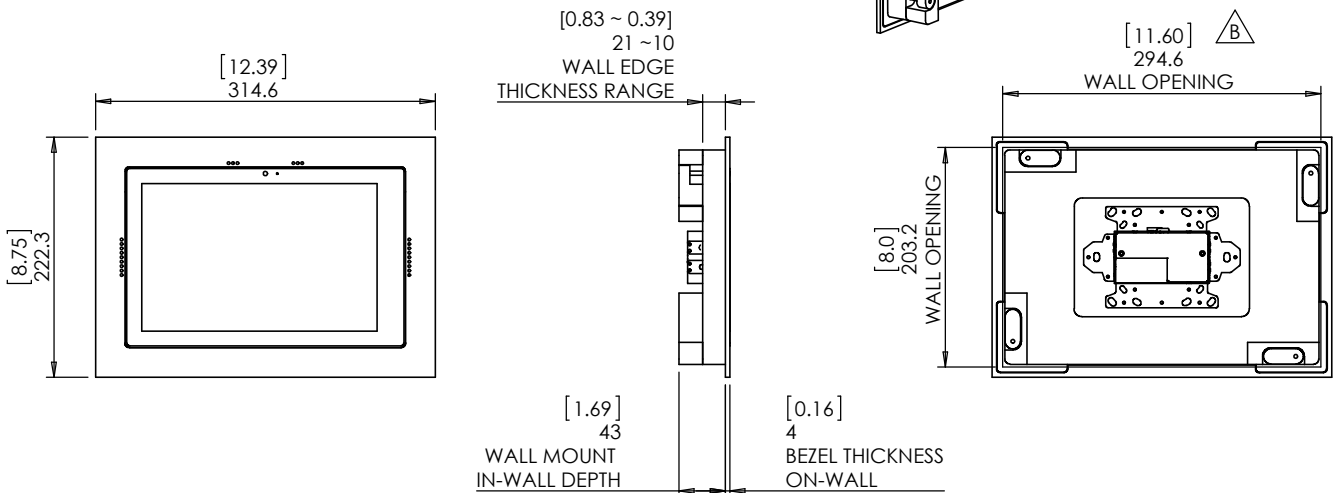



Model: WS RETROFIT FOR TSW-1060
BLACK/WHITE

Family: WALL-SMART

DWG NO. 10-04-756-SPC

Model No.: 10-01-756-BL/-WH

PRODUCT SPEC.

REVISION B

DATE 8/DEC./2017

