



Model: WS FOR TSD-2220 - RETROFIT BASE

Family: WALL-SMART

DWG NO. 10-04-722-SPC



Model No.: 10-01-722

PRODUCT SPEC.

REVISION A

DATE 27/Feb./2017

Make Your Wall Smart

“WS FOR TSD-2220 - RETROFIT BASE” - Product description:

The “WS FOR TSD-2220 - RETROFIT BASE” is an adapter for in-wall nearly flush retrofit installation of TSD-2220 touch screen (Base unit only, not including bezel).

The “WS FOR TSD-2220 - RETROFIT BASE” securely mounts the touch screen while allowing easy insertion, removal and operation.

Key features and benefits:

- Nearly flush with the wall (6mm [0.24"] thick on-wall bezel).
- Allows easy insertion and removal of the touch screen.
- Wall mount contains depth calibration screws.
- Designed for the use with TSD-2220 (by CRESTRON) (touch screen is not included).
- Adapter kit contains:

1. (X1) Wall adapter;
2. (X1) Screen adapter
3. (X4) M4x10 screws
4. (X4) M4 flat washer
5. (X6) Retention latches
6. (X6) M4x25 CS screws

- Order bezel separately:

p/n 10-01-723 WS FOR TSD-2220 - RETROFIT BEZEL WHITE

p/n 10-01-724 WS FOR TSD-2220 - RETROFIT BEZEL BLACK

p/n 10-01-725 WS FOR TSD-2220 - RETROFIT BEZEL WO.PAINT

Key properties:

- Dimensions: (W/H/D): 585mm (23")/ 385mm (15.16") / 89.5mm (3.52")
- Weight: 4.2Kg (9.2lbs).
- Material: Zinc plated carbon steel

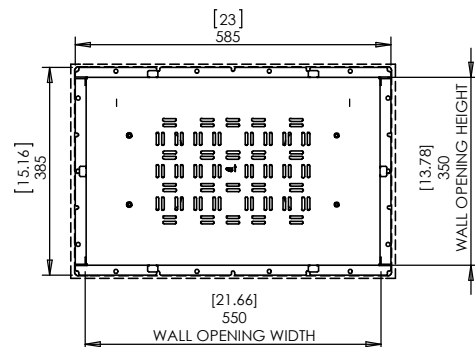
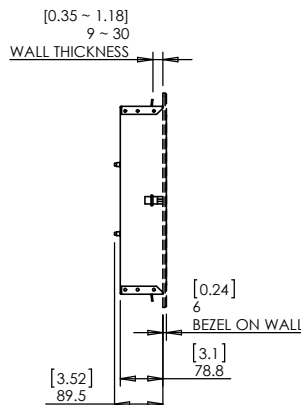
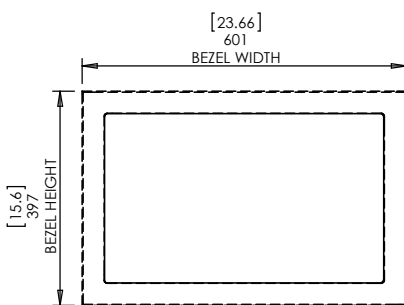
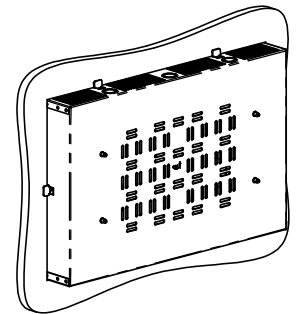
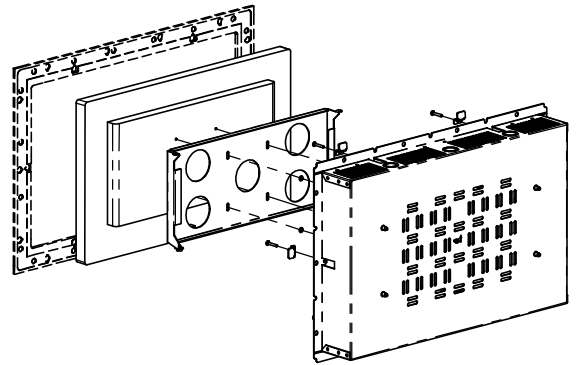
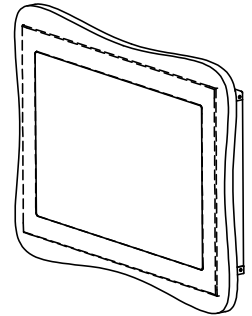
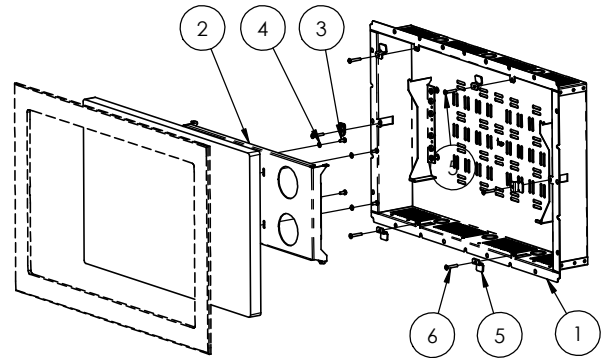



Model: WS FOR TSD-2220 -
RETROFIT BASE

Family: WALL-SMART

DWG NO. 10-04-722-SPC

Model No.: 10-01-722

PRODUCT SPEC.

REVISION A

DATE 27/Feb./2017

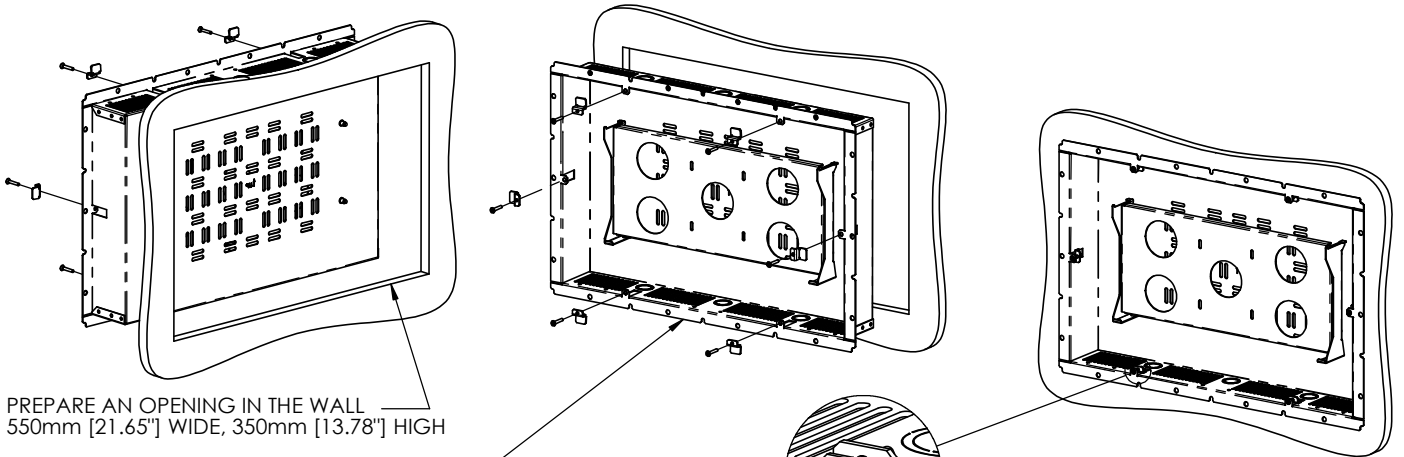

PREPARE AN OPENING IN THE WALL
550mm [21.65"] WIDE, 350mm [13.78"] HIGH

INSERT THE WALL MOUNT BASE INTO THE
OPENING, INSERT THE LATCHES AND RETAIN
THEM USING THE x4 M4x25 SCREWS

INSTALL SCREEN USING 4 M4X10 SCREWS AND 4 M4 WASHERS (INCLUDED)
(DO NOT TIGHTEN THE SCREWS)

IF REQUIRED, CALIBRATE VERTICAL POSITION OF THE
SCREEN BY ADJUSTING POSITION OF THESE 4 SCREWS.

IF REQUIRED, CALIBRATE SCREEN DEPTH BY ROTATING THESE 4 SCREWS ON BOTH
SIDES OF THE SCREEN.

INSERT THE SCREEN

POSITION THE BEZEL
(ORDER BEZEL SEPARATELY)