



Model: WS IN-WALL MOUNT FOR SONOS BEAM US&UK BLACK/WHITE

Model No.: 085-1-347-UBL/UWH

Family: WALL-SMART

DWG NO. 085-4-347-U-SPC

PRODUCT SPEC.

REVISION B

DATE 16/FEB/2022



Make Your Wall Smart

“WS IN-WALL MOUNT FOR SONOS BEAM ” - Product description:

The “WS IN-WALL MOUNT FOR SONOS BEAM” is an adapter for in-wall nearly flush installation of a SONOS Beam sound bar.

The “WS IN-WALL MOUNT FOR SONOS BEAM” conceals the sound bar while allowing easy access, removal and operation.

Key features and benefits:

- Nearly flush with the wall (7.6mm [0.3”] thick on-wall grille).
- Allows easy insertion and removal of the sound bar.
- Wall adapter includes knockouts to install US or UK backboxes and receptacles (See page 4 for backbox installation instructions) (to install an European backbox use 085-1-347-EBL/EWH “WS IN-WALL MOUNT FOR SONOS BEAM EU&IL BLACK/WHITE”)
- Wall adapter is designed for the use with the following backboxes:
 - UK – BS4662 2 Gang (or equivalent)
 - US – HUBBELL Racobox 420 (or equivalent)
- Wall adapter is designed for High Fidelity audio output
- Grille is supplied white (UWH) or black (UBL)
- Grille is made with high quality acoustic and IR transparent fabric
- Grille attaches magnetically to the wall mount base
- Wall Board thickness may be 9.1mm[0.36”] up to 18.4mm[0.72”]
- Designed for the use with Beam sound bar (by SONOS)(not included)
- Wall adapter is supplied unassembled (See page 3 for instructions)
- See page 2 for package content

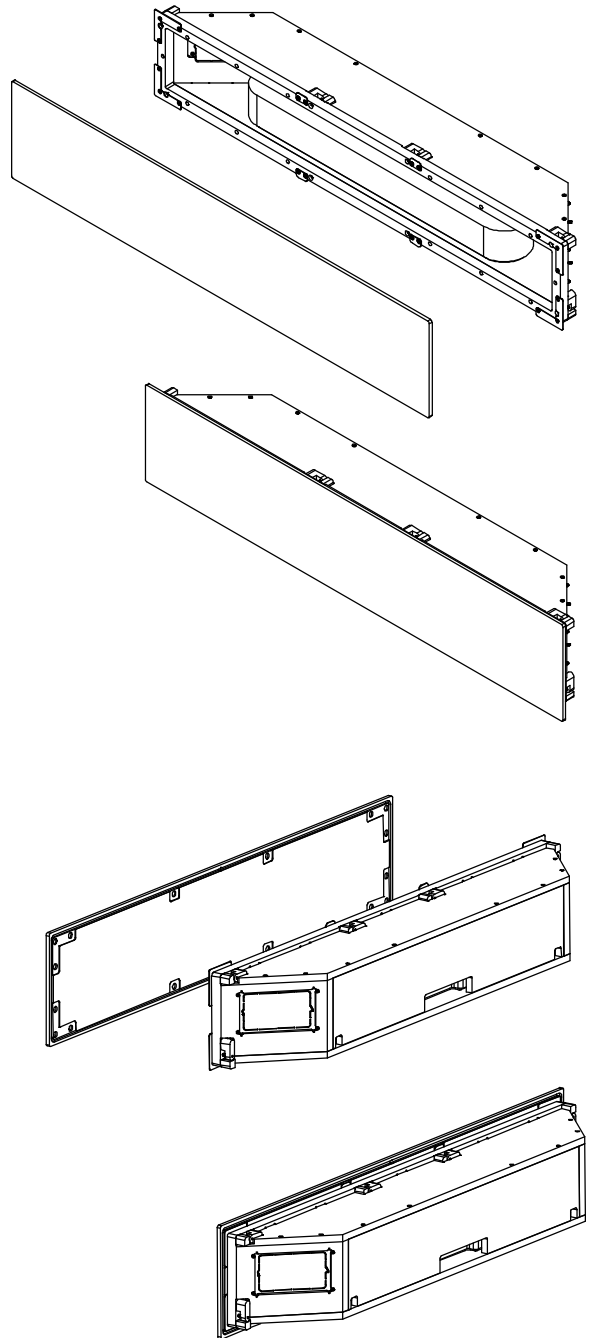

Key properties:

- Dimensions: (W/H/D): 1016mm (40”)/203.2mm (8”)/ 157.7mm (6.21”)
- Weight: 4.3Kg, 9.5lbs.
- Material: Moisture resistant MDF (compliant with TSCA Title VI)

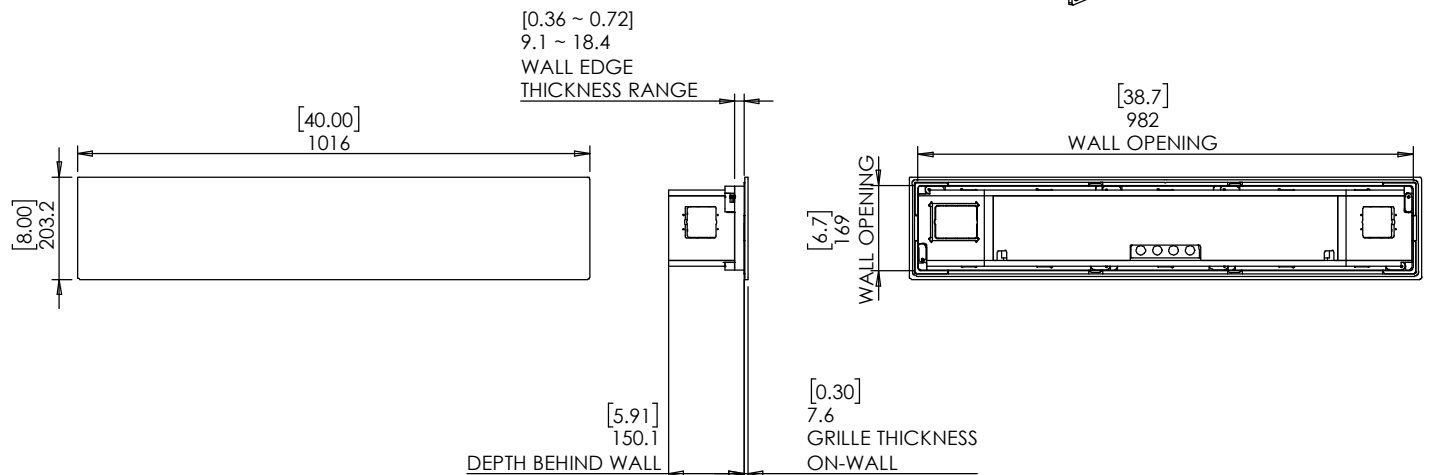



Model: WS IN-WALL MOUNT FOR SONOS
BEAM US&UK BLACK/WHITE

Family: WALL-SMART

DWG NO. 085-4-347-U-SPC



Model No.: 085-1-347-UBL/UWH

PRODUCT SPEC.

REVISION B

DATE 16/FEB/2022

Adapter kit contains:

1. Front frame (X1)
2. Back wall (X1)
3. Top/Bottom wall (X2)
4. Side wall US (X1)
5. Side wall Uk (X1)
6. Grille (X1)
7. ST3x25 screws (X30)
8. KA3.5x8 screws (x4)

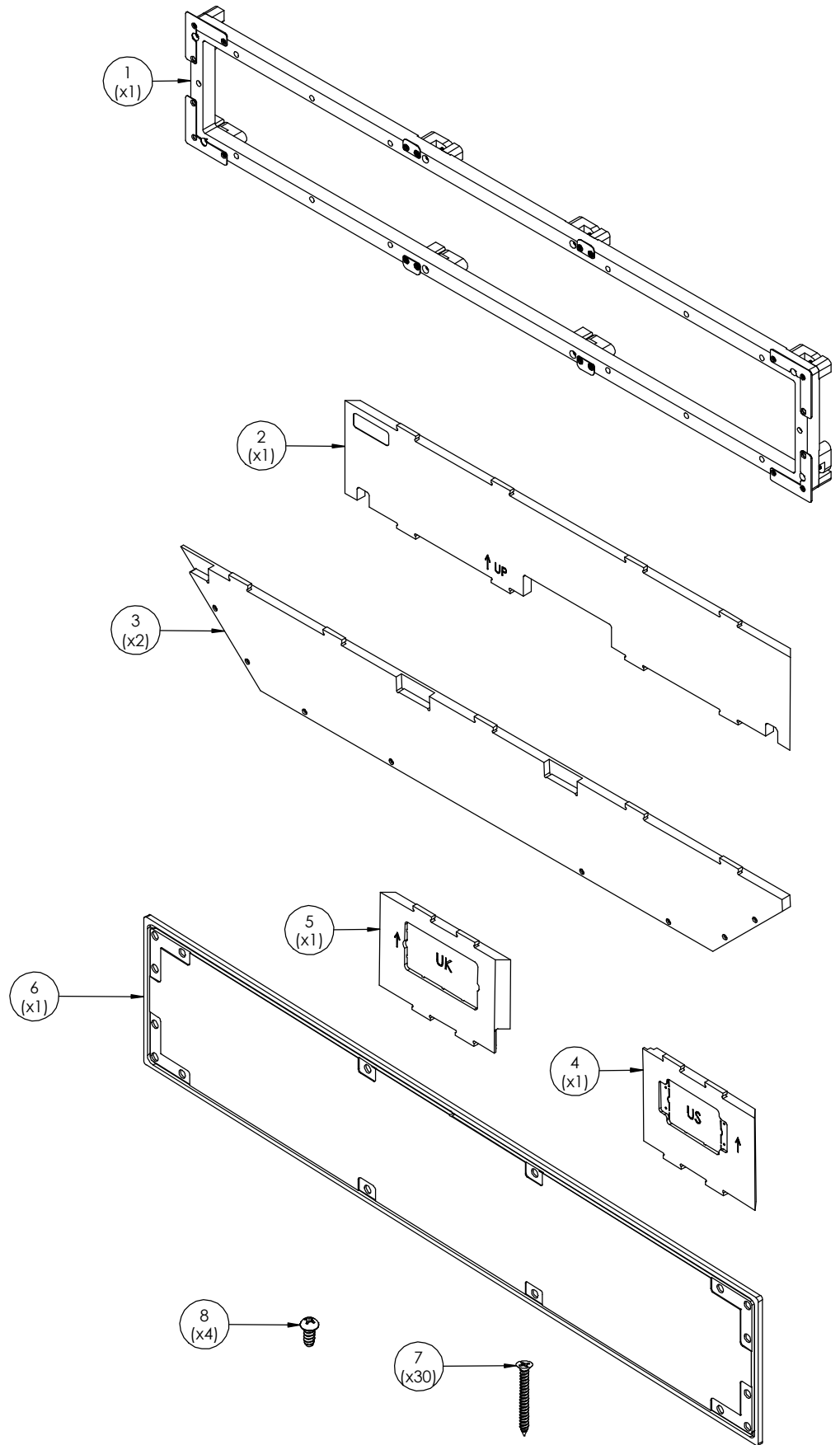



ASSEMBLY INSTRUCTIONS

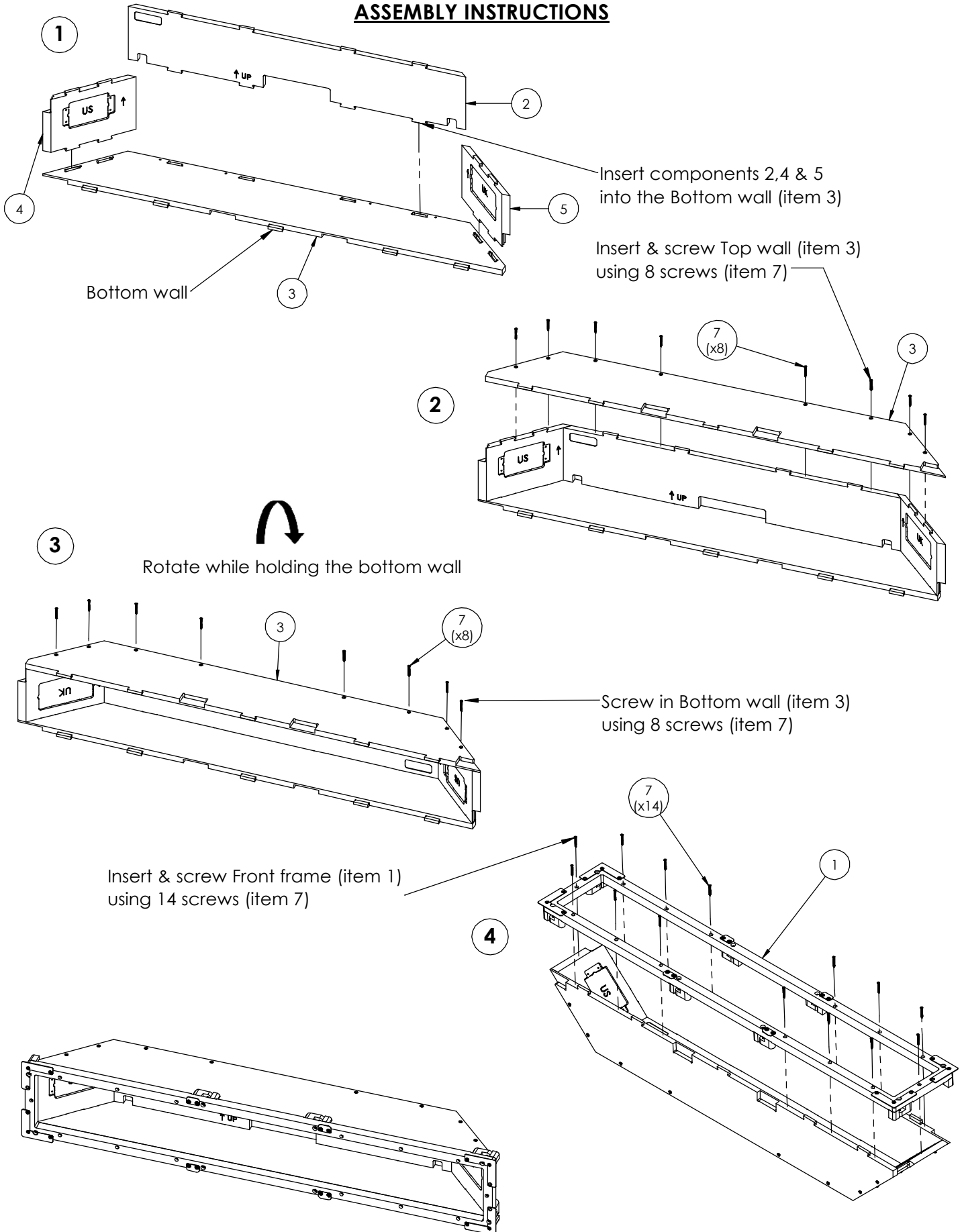



Model: WS IN-WALL MOUNT FOR SONOS
BEAM US&UK BLACK/WHITE

Family: WALL-SMART

DWG NO. 085-4-347-U-SPC

Model No.: 085-1-347-UBL/UWH

PRODUCT SPEC.

REVISION B

DATE 16/FEB/2022



US BACKBOX AND RECEPTACLE INSTALLATION

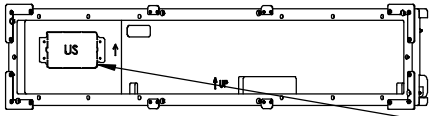

1. REMOVE US KNOCKOUT

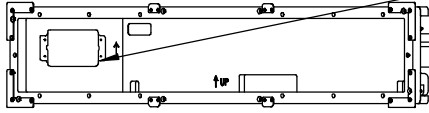

2. SCREW IN RACOBOX 420
(OR EQUIVALENT) AND INSTALL
RECEPTACLE

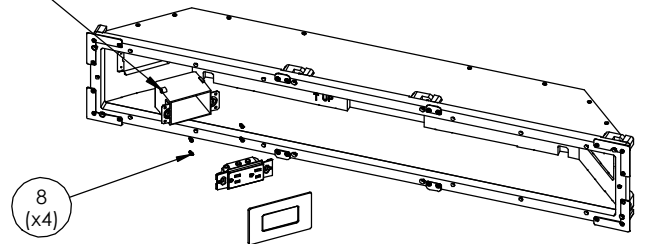

UK BACKBOX AND RECEPTACLE INSTALLATION

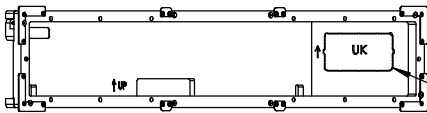

1. REMOVE UK KNOCKOUT

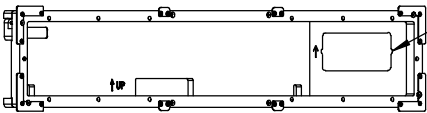

2. SCREW IN BS4662 2 GANG
BOX (OR EQUIVALENT)

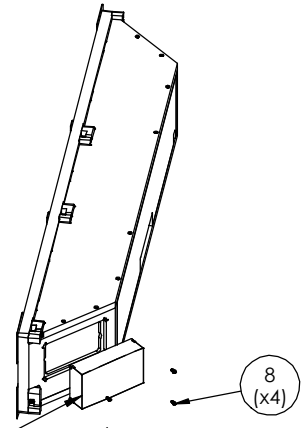

3. INSTALLL RECEPTACLE

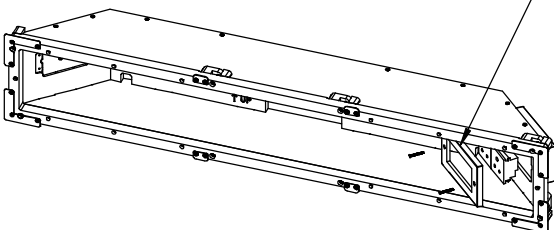



Model: WS IN-WALL MOUNT FOR SONOS
BEAM US&UK BLACK/WHITE

Family: WALL-SMART

DWG NO. 085-4-347-U-SPC



Model No.: 085-1-347-UBL/UWH

PRODUCT SPEC.

REVISION B

DATE 16/FEB/2022

WALL INSTALLATION

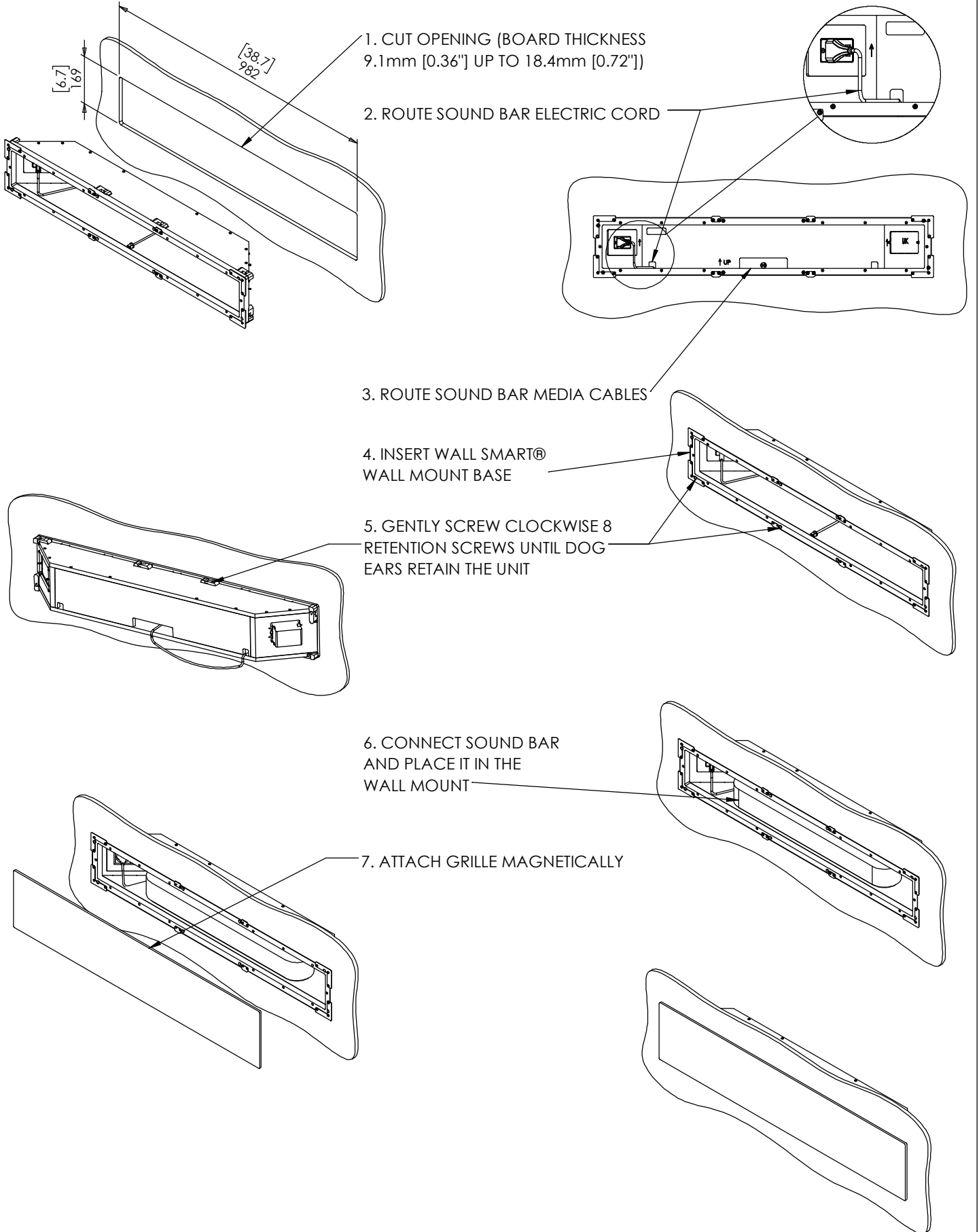

1. CUT OPENING (BOARD THICKNESS 9.1mm [0.36"] UP TO 18.4mm [0.72"])

2. ROUTE SOUND BAR ELECTRIC CORD

3. ROUTE SOUND BAR MEDIA CABLES

4. INSERT WALL SMART® WALL MOUNT BASE

5. GENTLY SCREW CLOCKWISE 8 RETENTION SCREWS UNTIL DOG EARS RETAIN THE UNIT

6. CONNECT SOUND BAR AND PLACE IT IN THE WALL MOUNT

7. ATTACH GRILLE MAGNETICALLY