



Model: WS SB FOR VIMAR 3M Eikon EVO Plates 21653

Family: WALL-SMART

DWG NO. 066-1-690-SPC



Model No.: 066-4-690

PRODUCT SPEC.

REVISION A
DATE 09/MAR/2020

Make Your Wall Smart

“WS SB FOR VIMAR 3M Eikon EVO Plates 21653” - Product description:

The “WS SB FOR VIMAR 3M Eikon EVO Plates 21653” is an adapter for in-wall flush installation of a VIMAR 3M Eikon EVO Plates 21653 in solid board walls.

The “WS SB FOR VIMAR 3M Eikon EVO Plates 21653” firmly mounts the keypad while allowing easy access, insertion and removal.

Key features and benefits:

- Allows easy insertion and removal by manual push.
- Wall mount contains depth calibration screws and spacer allowing installation in solid surface boards of 4.7 [0.18"] up to 33.4 [1.31"] thickness.
- Installation kit contain:
 1. X1 Wall adapter
 2. X1 Routing template
 3. X4 ST3x40 screws
- Designed for the use with VIMAR 3M Eikon EVO Plates 21653 (switch, face plate and accessories not included)

Key properties:

- Dimensions (W/H/D): 156.8mm (6.17")/ 136.1mm (5.36")/ 45.6mm (1.8")
- Power Supply: None (manual adapter).
- Weight: 0.4Kg, 0.88lbs.
- Material: Moisture resistant MDF (compliant with TSCA Title VI)

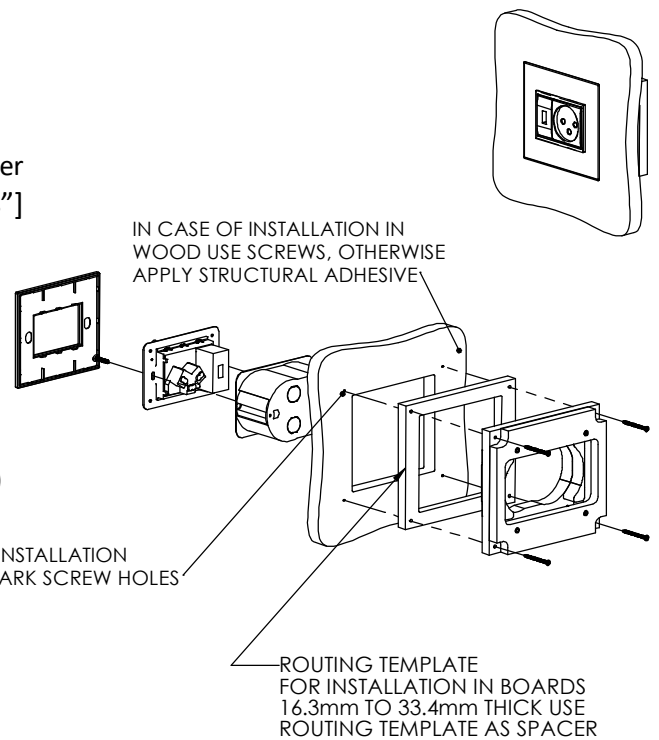
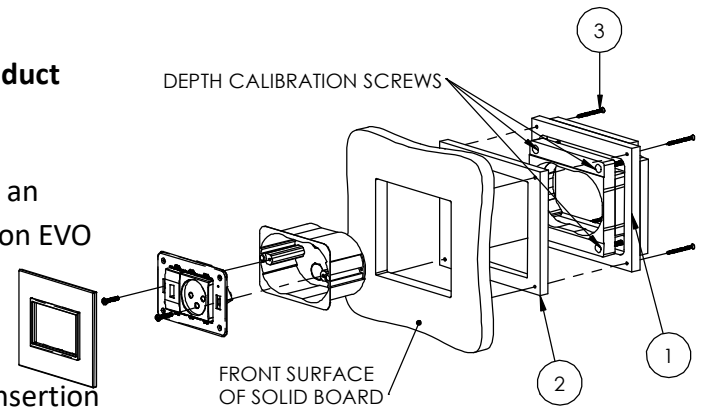

SOLID BOARD THICKNESS RANGE:
4.7~ 21.7 [0.18~0.85] WITH SPACER
16.3 ~ 33.4 [0.64~1.31] WITHOUT SPACER

2 Gang European Flush-mount box
p/n V71703 by VIMAR
or equivalent

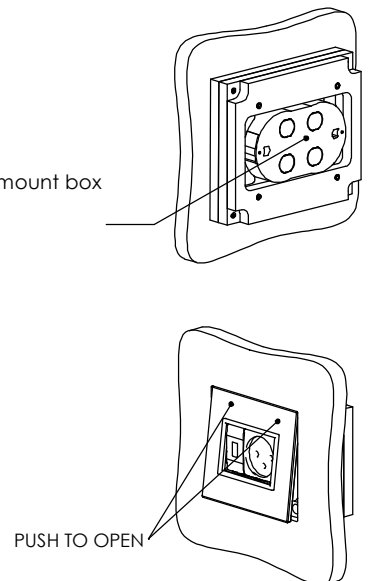
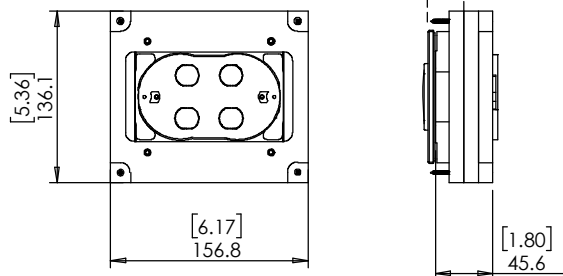



Model: WS SB FOR VIMAR 3M
Eikon EVO Plates 21653

Family: WALL-SMART

DWG NO. 066-1-690-SPC



Model No.: 066-4-690

PRODUCT SPEC.

REVISION A

DATE 09/MAR/2020

ROUTING TEMPLATE

MARK SCREW
LOCATIONS

